

Typical Floor Plan

E Wing - 1st to 7th Floor

FLAT NO.: 101, 201, 301, 401, 501, 601, 701		
2 BHK	[Sq. Mt.]	[Sq. Ft.]
CARPET	54.30	584.50
BALCONY	14.79	159.19
TOTAL USABLE	69.09	743.69

FLAT NO.: 102, 202, 302, 402, 502, 602, 702		
2 BHK	[Sq. Mt.]	[Sq. Ft.]
CARPET	54.03	581.58
BALCONY	10.83	116.57
TOTAL USABLE	64.86	698.15

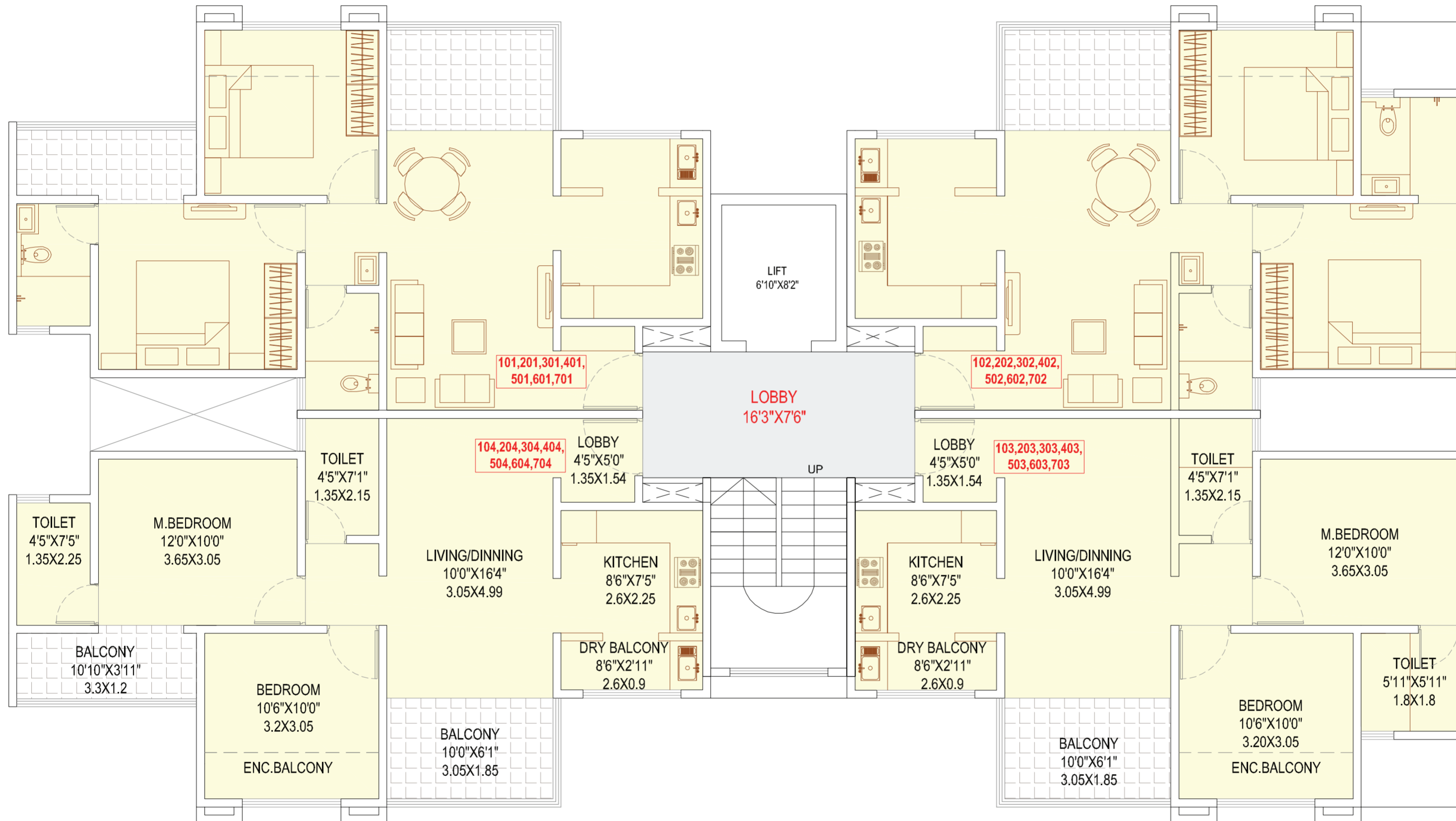

FLAT NO.: 104, 204, 304, 404, 504, 604, 704		
2 BHK	[Sq. Mt.]	[Sq. Ft.]
CARPET	54.30	584.50
BALCONY	14.79	159.19
TOTAL USABLE	69.09	743.69

FLAT NO.: 103, 203, 303, 403, 503, 603, 703		
2 BHK	[Sq. Mt.]	[Sq. Ft.]
CARPET	54.03	581.58
BALCONY	10.83	116.57
TOTAL USABLE	64.86	698.15

